

1 2 3 4 5 6 7 8 9

ANGLE	± 5°	REV	LOCAS	DESCRIPTION	DESIGN	DATE	卫国峰
X.XXX	± 0.05	01			DRAWN	DATE	尚伟
X.XX	± 0.15	02			CHECKED	DATE	吴汉学
X.X	± 0.25	03			AUDITED	DATE	龚劲松
X	± 0.50	04			APPROVED	DATE	eric

**Specifications/备注 (Remark)**

**1-材料 (MATERIAL)**

端子: 磷青铜

Contact: Phosphor bronze

**2-特性 (characteristics):**

额定电压: 250V AC/DC .

Voltage Rating: 250V AC/DC .

额定电流: 10 AMP (AWG #16-22) .

Rating Current: 10 AMP (AWG #16-22) .

接触阻抗: ≤ 10mΩ MAX.

Contact Resistance: ≤ 10mΩ MAX .

绝缘阻抗: ≥ 1000MΩMIN.

Insulating Resistance: ≥ 1000MΩMIN.

耐电压: 1500V AC/MINUTE

Withstanding Voltage: 1500V AC/MINUTE

温度范围: -25度至+85度

Temperture Range: -25°Cto +85°C

**ORDERING INFORMATION**

**T396- XX X X**

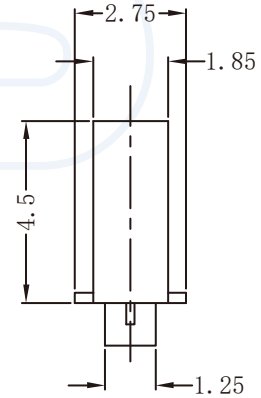
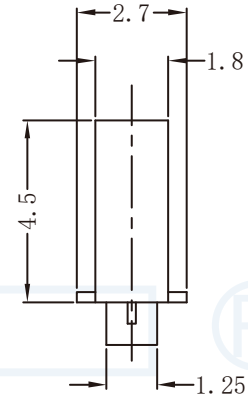
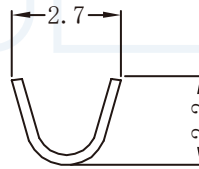
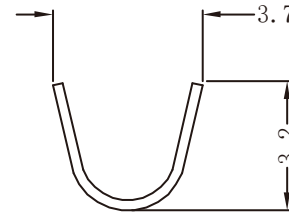
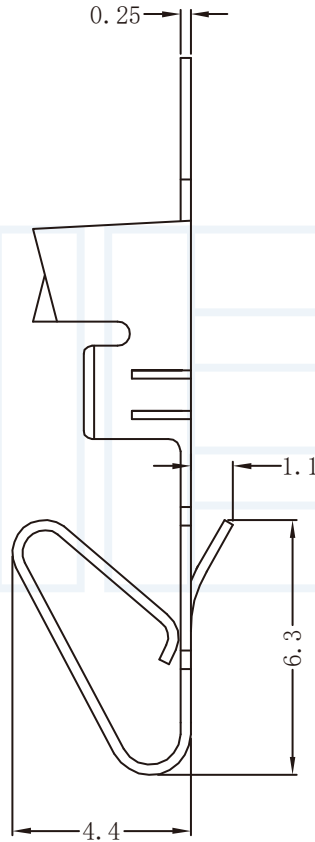
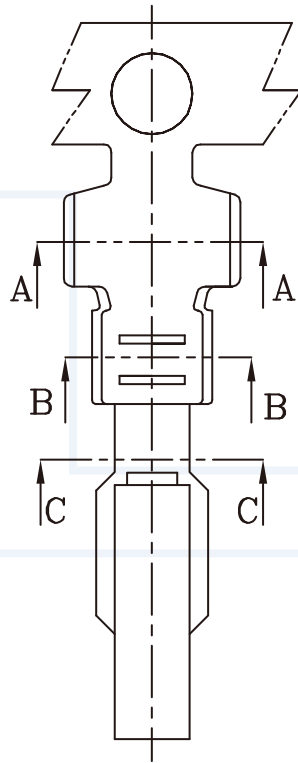
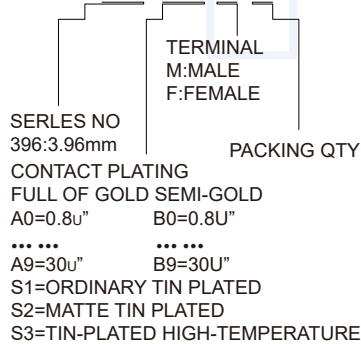

**YLIES** 东莞市瑞翔精密连接器有限公司  
DONG GUAN YLIES PRECISE CONNECTOR CO.,LTD

Tel:0769-85381995 / Fax:0769-85493987 / Email: ylies@ylies.cn / Web:www.ylies.cn

TITLE 422-3.96mm 端子 (2139) DATE 2018-02-18

PROJECTON REV A UNIT mm SCALE 1:1 PAGE 1/1

PART NO: T396-S1X3 DRAWING NO:

1 2 3 4 5 6 7 8 9