

ANGLE	± 5°	REV	LOCAS	DESCRIPTION	DESIGN	DATE	卫国峰
X.XXX	± 0.05	01			DRAWN	DATE	尚伟
X.XX	± 0.15	02			CHECKED	DATE	吴汉学
X.X	± 0.25	03			AUDITED	DATE	龚劲松
X	± 0.50	04			APPROVED	DATE	eric

Specifications/备注 (Remark)

1-材料 (MATERIAL)
 胶芯: PA46 UL94V-0
 Housing: PA46 UL94V-0
 端子: 黄铜
 Contact: Brass

2-特性 (characteristics):
 额定电压: 50V AC/DC .
 Voltage Rating: 50V AC/DC .
 额定电流: 2 AMP (AWG #24-30) .
 Raring Current: 2 AMP (AWG #24-30) .
 接触阻抗: ≤10mΩ MAX.
 Contact Resistance: ≤10mΩ MAX.
 绝缘阻抗: ≥1000MΩMIN.
 Insulating Resistance: ≥1000MΩMIN.
 耐电压: 100V AC/MINUTE
 Withstanding Voltage: 100V AC/MINUTE
 温度范围: -25度至+85度
 Temperture Range: -25°Cto +85°C

ORDERING INFORMATION

W20-XX XX X XX X

NO.OF PINS Per Row 02-16P	INSULATOR MATERIAL A:PA46 B:PA66 C:PA9T D:LCP	PACKING A:PE Bag B:TUBE C:TRAY
SERLES NO 20:2.0mm	CONTACT PLATING FULL OF GOLD SEMI-GOLD A0=0.8u" B0=0.8U"	CONTACT SHAPE S: Straight R: Right Angle LT: STRAIGHT SMT WT: RIGHT ANGLE SME
.....
A9=30u" B9=30U"	S1=ORDINARY TIN PLATED S2=MATTE TIN PLATED S3=TIN-PLATED HIGH-TEMPERATURE	

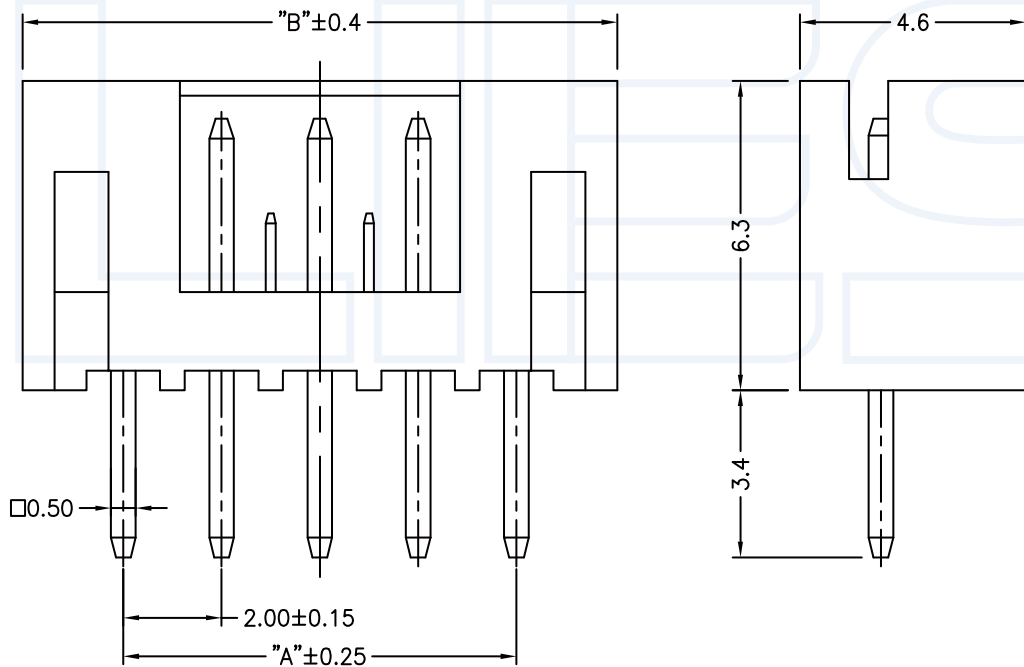
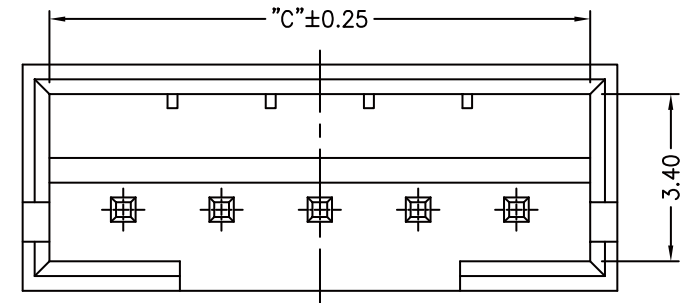

Poles	DIM.A	DIM.B	DIM.C
2P	2.0	6.1	5.0
3P	4.0	8.1	7.0
4P	6.0	10.1	9.0
5P	8.0	12.1	11.0
6P	10.0	14.1	13.0
7P	12.0	16.1	15.0
8P	14.0	18.1	17.0
9P	16.0	20.1	19.0
10P	18.0	22.1	21.0
11P	20.0	24.1	23.0
12P	22.0	26.1	25.0
13P	24.0	28.1	27.0
14P	26.0	30.1	29.0
15P	28.0	32.1	31.0
16P	30.0	34.1	33.0

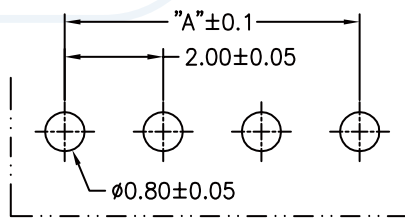

P.C.B LAYOUT

YLIES 东莞市瑞翔精密连接器有限公司
 DONG GUAN YLIES PRECISE CONNECTOR CO.,LTD

TITLE: 361-2.0mm 单排插针180度 DATE: 2018-02-18

Tel:0769-85381995 / Fax:0769-85493987 / Email: ylies@ylies.cn / Web:www.ylies.cn

PROJECTON REV A UNIT mm SCALE 1:1 PAGE 1/1

PART NO: W20-05S1BSA DRAWING NO: