

1 2 3 4 5 6 7 8 9

ANGLE	± 5°	REV	LOCAS	DESCRIPTION	DESIGN	DATE	卫国峰
X.XXX	± 0.05	01			DRAWN	DATE	尚伟
X.XX	± 0.15	02			CHECKED	DATE	吴汉学
X.X	± 0.25	03			AUDITED	DATE	龚劲松
X	± 0.50	04			APPROVED	DATE	eric

Specifications/备注 (Remark)

- 1-材料 (MATERIAL)
端子: 磷青铜
Contact: Phosphor bronze
- 2-特性 (characteristics):
额定电压: 125V AC/DC .
Voltage Rating:125V AC/DC .
额定电流: 1 AMP (AWG #28-30) .
Raring Current:1 AMP (AWG #28-30) .
接触阻抗: ≤20mΩ MAX.
Contact Resistance:≤20mΩ MAX .
绝缘阻抗: ≥100MΩMIN.
Insulating Resistance:≥100MΩMIN.
耐压: 250V AC/MINUTE
Withstanding Voltage:250V AC/MINUTE
温度范围: -25度至+85度
Temperature Range: -25°Cto +85°C

ORDERING INFORMATION

T125- XX X X

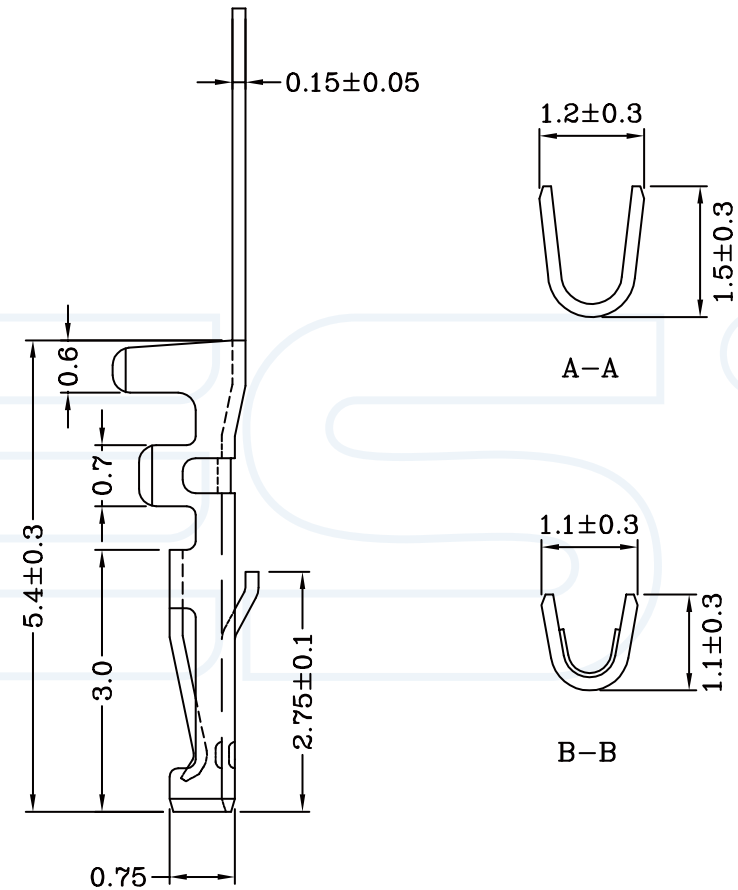
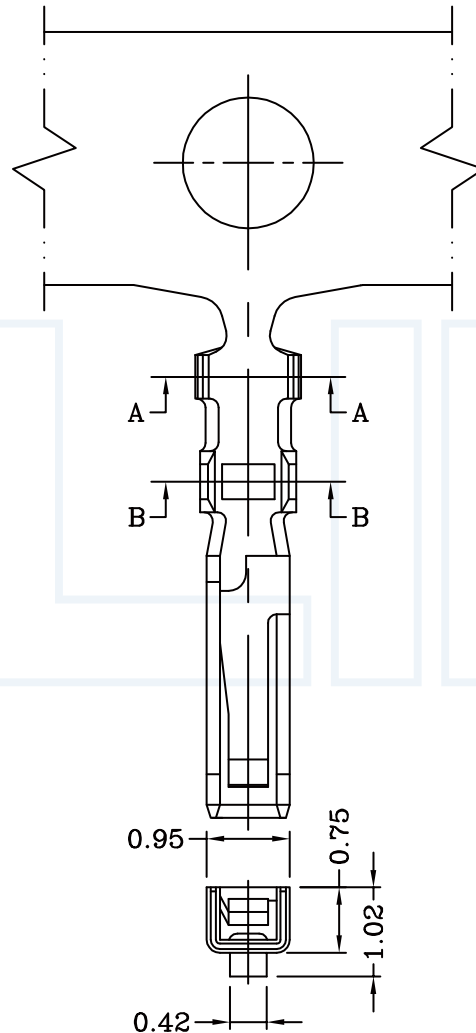
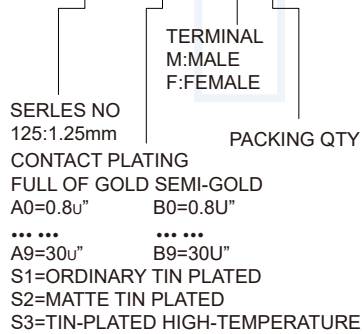

Wire Range	Insulation O.D.	Material
AG #28~#30	0.90mm(max)	Phosphor Bronze

YLIES 东莞市瑞翔精密连接器有限公司
DONG GUAN YLIES PRECISE CONNECTOR CO.,LTD

Tel:0769-85381995 / Fax:0769-85493987 / Email: ylies@ylies.cn / Web:www.ylies.cn

TITLE

350-1.25mm 端子-B

DATE

2018-02-18

PROJECTON

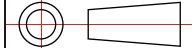

REV
A

UNIT
mm

SCALE
1:1

PAGE
1/1

PART NO:

T125-S1XC

DRAWING NO:

1 2 3 4 5 6 7 8 9