

ANGLE	± 5°	REV	LOCAS	DESCRIPTION	DESIGN	DATE	卫国峰
X.XXX	± 0.05	01			DRAWN	DATE	尚伟
X.XX	± 0.15	02			CHECKED	DATE	吴汉学
X.X	± 0.25	03			AUDITED	DATE	龚劲松
X	± 0.50	04			APPROVED	DATE	eric

Specifications/备注 (Remark)

Insulator:Black glass filled polyester
 PPS-GF30-FR
 Fiammability:UL94V-0
 Sleeve:Brass CuZn 36Pb3(36000)
 Contact clip(4 finger):Beryllium copper(C17200)
 Mating pin:Ø0.70 to 0.90mm or 0.635mmSQ
 Forces:(polished steel gauge Ø0.76mm)
 Insertion:1.2 N typ
 Withdrawal:0.6 N typ
 Mechancial life:min 500 cycles
 Rated current:3.0Amp
 Contact resistance:Max 10mΩ
 Dielectric resistance:Min 1000V RMS

Stright socket connector low profile heght2.8mm:solder tail, double row, low profie
 Availability from:2 to 40 contacts
 Standard number of contacts 40

Stright socket connector low profile heght2.8mm:solder tail, double row, low profie
 Availability from:2 to 80 contacts
 Standard number of contacts 80

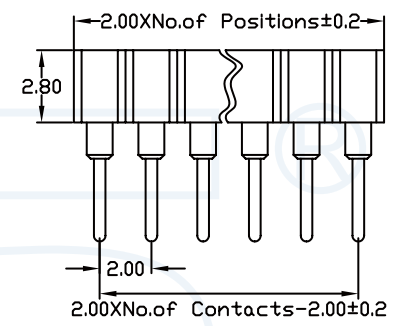
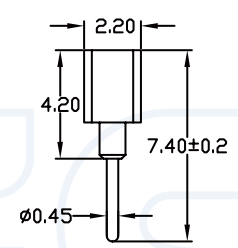
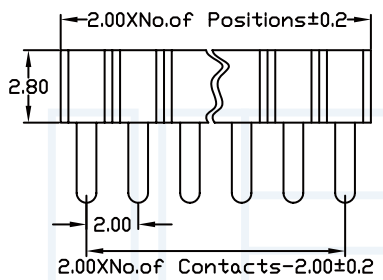
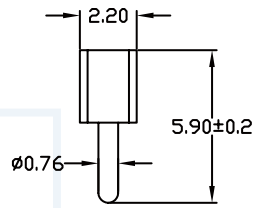

ORDERING INFORMATION
R2528-X XX X XG S XXX 1

HEIGHT OF HOUSING: 28:2.8mm
 NO. OF ARRAY PITCH: 0:NO PITCH 2:2.0mm
 INSULATOR MATERIAL: G:PPS
 NO. OF ROW: 1:SINGLE ROW 2:DUAL ROW
 NO. OF PINS PER ROW: 02-40P
 CONTACT PLATING LENGTH OF TERMINAL
 A=1U" 059:5.9mm
 B=2U" 074:7.40mm

 E=15U"
 F=30U"
 S=ORDINARY TIN PLATED
 H=HALF GOLD PLATED TIN

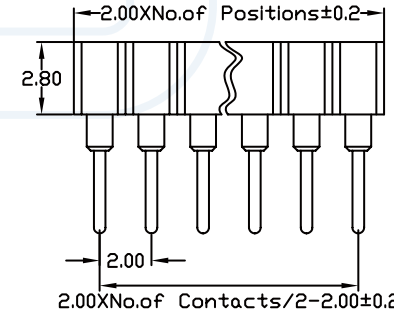
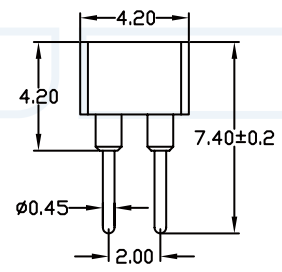
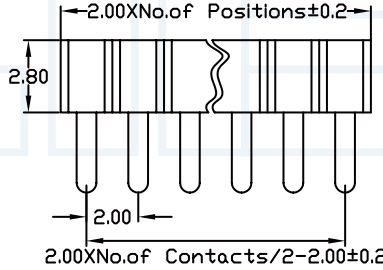
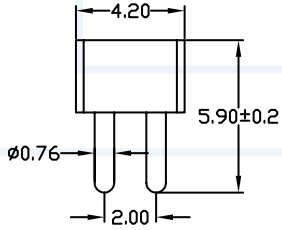

Stright socket connector heght 4.2mm:solder tail,
 Availability from:2 to 40 contacts
 Standard number of contacts 40

Stright socket connector heght 4.2mm:solder tail,
 Availability from:4 to 80 contacts
 Standard number of contacts 80