

ANGLE	± 5°	REV	LOCAS	DESCRIPTION	DESIGN	DATE	卫国峰
X.XXX	± 0.05	01			DRAWN	DATE	尚伟
X.XX	± 0.15	02			CHECKED	DATE	吴汉学
X.X	± 0.25	03			AUDITED	DATE	龚劲松
X	± 0.50	04			APPROVED	DATE	eric

**Specifications/备注 (Remark)**

**1-材料 (MATERIAL)**

胶芯: PPS+30%G. UL94V-0, 颜色: 黑色  
 Housing: PPS+30%G. UL94V-0, Color: Black  
 端子: 黄铜

Contact: Brass CuZn 36Pb3 (C3600)

相配针:  $\phi$  0.47mm

Connecting Pin:  $\phi$  0.47mm

**2-特性 (characteristics):**

额定电流: 3.00 AMP

Rating Current: 3.00 AMP

接触阻抗: 10m $\Omega$  MAX.

Contact Resistance: 10m $\Omega$  MAX.

绝缘阻抗: 1000M $\Omega$ MIN.

Insulating Resistance: 1000M $\Omega$ MIN.

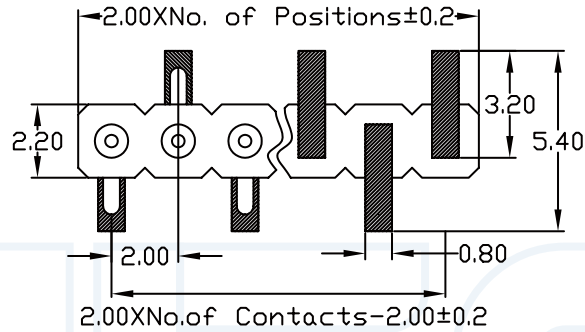
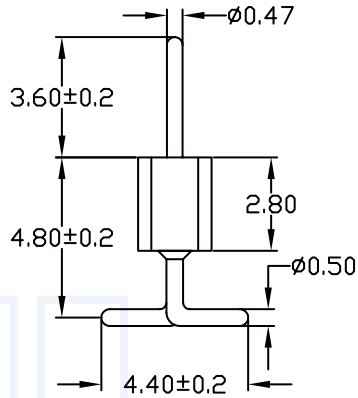

SMT socket connector: single row  
 perpendicular mount  
 Availability from: 2 to 40 contacts  
 Standard number of contacts 40

**ORDERING INFORMATION**  
**R1528-X XX X X G M 100 1**

HEIGHT OF HOUSING: 28:2.8mm	NO. OF ARRAY PITCH 0:NO PITCH 2:2.00mm	INSULATOR MATERIAL: G:PPS
NO. OF ROW: 1:SINGLE ROW 2:DUAL ROW	NO. OF PINS PER ROW: 02-40P	CONTACT PLATING A=1U" B=2U" ... .. E=15U" F=30U" S=ORDINARY TIN PLATED H=HALF GOLD PLATED TIN
		LEHGH OF TERMINAL

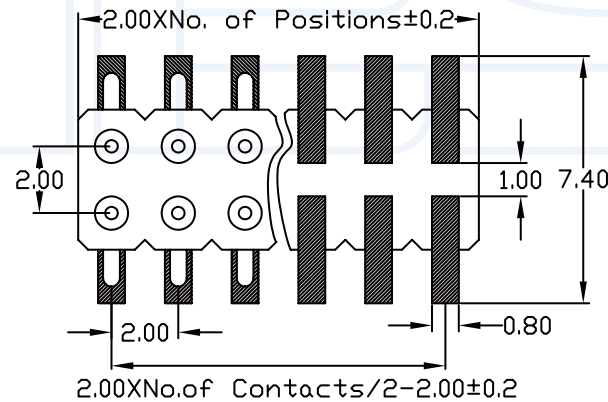
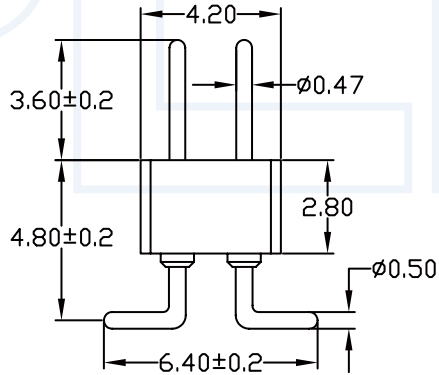

SMT socket connector: single row  
 perpendicular mount  
 Availability from: 4 to 80 contacts  
 Standard number of contacts 80

**YLIES** 东莞市瑞翔精密连接器有限公司  
 DONG GUAN YLIES PRECISE CONNECTOR CO.,LTD

Tel:0769-85381995 / Fax:0769-85493987 / Email: ylies@ylies.cn / Web:www.ylies.cn

PROJECTON	REV	UNIT	SCALE	PAGE	PART NO:	DRAWING NO:
	A	mm	1:1	1/1	R1528-XXXXXGM1001	

TITLE

250-2.0mm 圆孔排针 SMT

DATE

2018-02-18