

| ANGLE | ± 5°   | REV | LOCAS | DESCRIPTION | DESIGN   | DATE | 卫国峰  |
|-------|--------|-----|-------|-------------|----------|------|------|
| X.XXX | ± 0.05 | 01  |       |             | DRAWN    | DATE | 尚伟   |
| X.XX  | ± 0.15 | 02  |       |             | CHECKED  | DATE | 吴汉学  |
| X.X   | ± 0.25 | 03  |       |             | AUDITED  | DATE | 龚劲松  |
| X     | ± 0.50 | 04  |       |             | APPROVED | DATE | eric |

**Specifications/备注 (Remark)**

**1-材料 (MATERIAL)**

胶芯: PPS+30%G. UL94V-0, 颜色: 黑色  
 Housing:PPS+30%G. UL94V-0,Color:Black  
 端子: 黄铜  
 Contact: Brass CuZn 36Pb3 (C3600)  
 相配针:  $\phi$  0.41mm  
 Connecting Pin:  $\phi$  0.41mm

**2-特性 (characteristics):**

额定电流: 1.0 AMP  
 Raring Current:1.0AMP .  
 接触阻抗: 10m $\Omega$  MAX.  
 Contact Resistance:10m $\Omega$  MAX .  
 绝缘阻抗: 1000M $\Omega$ MIN.  
 Dielectric strength:Min 1000V RMS

Right socket connector:solder tail  
 single row  
 Availability from:2 to 50 contacts  
 Standard number of contacts 25 and  
 50

Right socket connector:solder tail  
 double row  
 Availability from:4 to 100 contacts  
 Standard number of contacts 50 and  
 100

**ORDERING INFORMATION**

**R13XX-X XX X X G R 103 1**

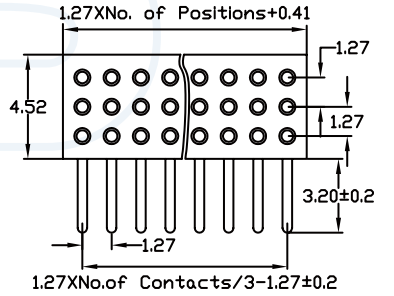
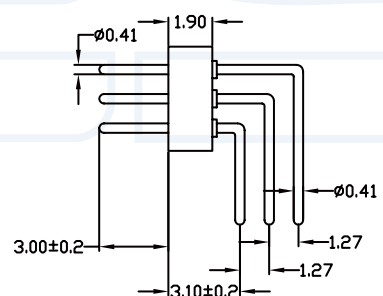
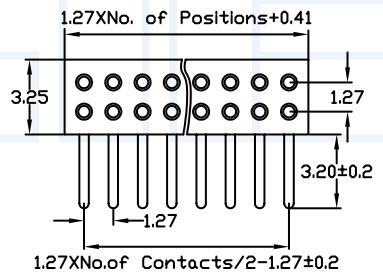
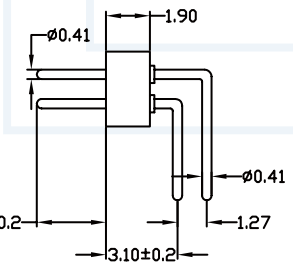
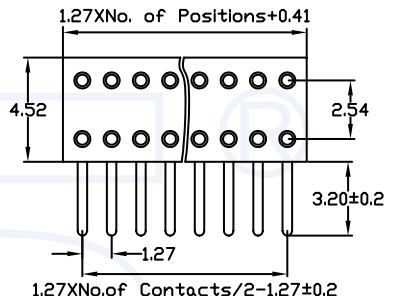
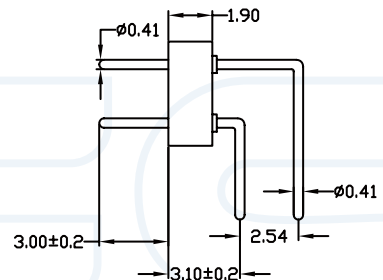
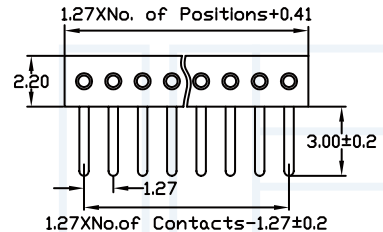
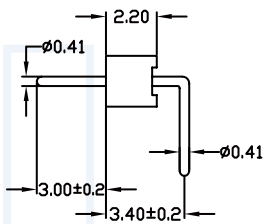
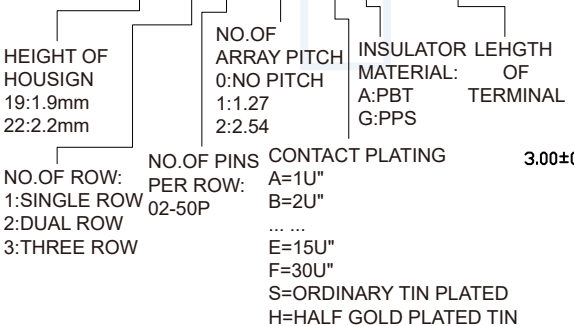

Right socket connector:solder tail  
 double row with 2.54mm rowto row  
 distance  
 Availability from:4 to 100 contacts  
 Standard number of contacts 100

Right socket connector:solder tail  
 triple row  
 Availability from:6 to 150 contacts  
 Standard number of contacts 150

**YLIES** 东莞市瑞翔精密连接器有限公司  
 DONG GUAN YLIES PRECISE CONNECTOR CO.,LTD

Tel:0769-85381995 / Fax:0769-85493987 / Email: ylies@ylies.cn / Web:www.ylies.cn

TITLE 238-1.27mm 圆孔排针 90度 DATE 2018-02-18

PROJECTON REV A UNIT mm SCALE 1:1 PAGE 1/1

PART NO: R13XX-XXXXXGR1031 DRAWING NO: